



Dexcom, Inc. | Corporate Headquarters  
6340 Sequence Drive | San Diego, CA 92121  
888.738.3646 | dexcom.com

**Date:** January 2025

**Urgent: Field Safety Notice - Initial**  
**Dexcom G6 Receiver – FAS-SD-24-003 - US-MF-000010694**

Attention: Valued Dexcom Customer,

We are contacting you as Dexcom recently became aware that users of certain G6 Receivers may experience an issue where alarm/alerts may not function as designed. In rare instances, the alarm/alert may be missed or delayed. We have identified the source of the issue and have designed a software update to solve this. Please read this message as it will help you identify if your Dexcom G6 receiver is in need of a software update.

**Details on affected devices:**

This field safety notification applies ONLY to users of Dexcom G6 Receivers with the part number listed in Table 1 below (refer to images on page 3):

**Table 1: Impacted G6 Receiver Information – EMEA + Asia Pacific (outside of Japan)**

Part Number	SKUs	Part Description	SW #
MT24078-1	STK-GS-013, STR-GS-004	Dexcom G6 Receiver – mg/dL	SW11712
MT24078-2	STK-GS-120, STK-GS-109, STR-GS-103, STR-GS-102	Dexcom G6 Receiver – mmol/L	SW11713

**Note:** *If you have already performed a firmware update related to this issue, you do not need to perform any additional firmware update for this same issue.*

**Description of the problem:**

Users of the Dexcom G6 Receiver with the impacted software have reported an issue in a small percentage of devices which manifests as follows:

- Receiver may not alert as designed including missed or delayed alarm/alerts
- Missed/delayed alarm/alerts may include: Low/High Glucose Alerts, Urgent Low Alarm, Urgent Low Soon Alert, Rise/Fall Rate Alerts, Signal Loss Alert, or Sensor Alert

**Note:** CGM Glucose Values and Glucose Trend Information continue to be displayed on the receiver

We are working to provide a path whereby users can update their receiver to resolve this issue. In the meantime, we recommend that you:

- If available, use the G6 App as primary display device to receive glucose readings and alerts. The G6 transmitter allows simultaneous communication with an iOS or Android device as well as a receiver. The G6 App is not impacted by the issue documented in this notification and may be used

in addition to or instead of the optional G6 Receiver. The G6 App can be installed on your compatible smartphone by visiting the Apple Store or Google Play Store. For compatible devices and operating systems see: <https://www.dexcom.com/compatibility>.

- If using an affected G6 Receiver, check CGM glucose values and glucose trend regularly as CGM glucose values and glucose trend graph information continue to be displayed. If you receive an alarm or alert, always check your glucose value prior to taking any additional steps.
- If you believe you may be experiencing the missed or delayed alarm/alerts issue, the issue can be corrected by shutting down the receiver and then turning it back on. Note: If the same triggering conditions occur after the reset, the issue may reoccur.

#### Steps to shut down and turn back on the receiver:

- Go to the receiver menu. The “menu” icon looks like this:



- Scroll-down until the “shutdown” option is visible
- Select the “shutdown” option
- Turn the receiver back on by pressing the select button for 3-5 seconds
- The use of optional alerts may increase the likelihood of getting an alert and is recommended. Always check your glucose value when receiving an alert, prior to taking any additional steps.
- Do not ignore low/high symptoms; if the presence or absence of glucose alarm/alerts do not match what you are feeling, use your blood glucose meter (BGM) to make diabetes treatment decisions or, if needed, seek immediate medical attention.

#### **Recommended Customer Action:**

**If you are or plan to be an active user of an affected Dexcom G6 Receiver, please complete the following actions related to an important software update:**

1. Please navigate to the following webpage on your internet browser using your tablet or computer: [\[URL - PLACEHOLDER\]](#)
2. Please read the information provided on the webpage and any recommended actions regarding a software update for your receiver to permanently resolve this issue.

**If you are not and do not plan to be an active user of an affected Dexcom G6 Receiver, no further additional action is needed.** Examples of where this may apply include if you have switched to a non-G6 CGM product or if you have permanently discontinued use of your G6 receiver in favor of a different display device.

#### **Contact reference information:**

If you need assistance in fulfilling any of the steps outlined above or on the referenced webpage, please call **Dexcom Technical Support** at [\[INSERT APPLICABLE TS CONTACT PHONE NUMBER\]](#).

# Dexcom

Dexcom, Inc. | Corporate Headquarters  
6340 Sequence Drive | San Diego, CA 92121  
888.738.3646 | dexcom.com

The part number is listed on the back of the receiver as shown in the image to the right/below:

**Front of Receiver  
Example Rendering:**

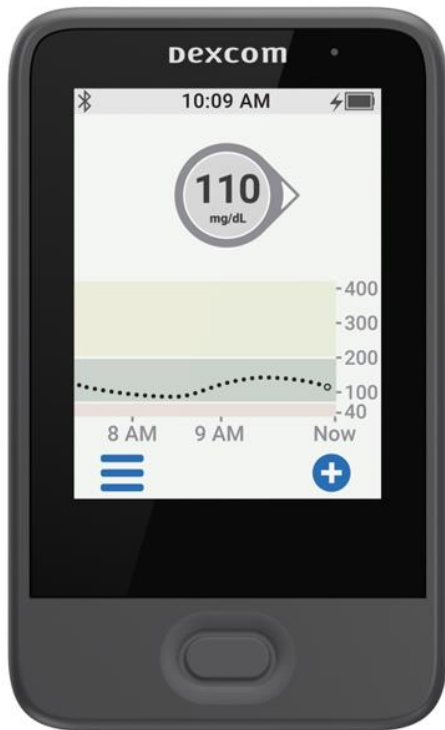

**Back of Receiver  
Example Rendering:**

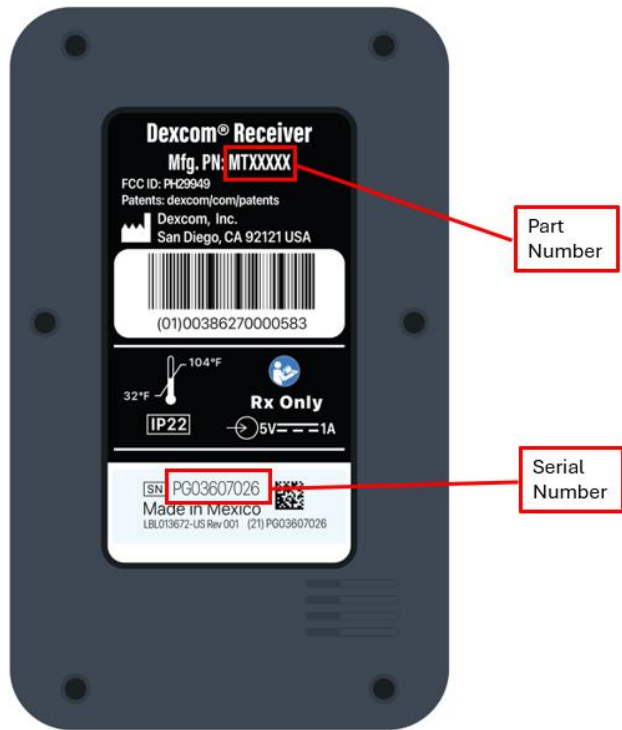

**Note:** If your receiver does not look like the images above and has a different part number, then it is not affected.

It is important that users of affected G6 receivers maintain awareness of the information and recommended actions provided in this safety notice, until those actions and associated updates have been completed. Active G6 Receiver users will receive an additional communication regarding the software update.

This issue has been reported to the applicable regulatory authorities. Please report all device-related suspected serious incidents to the manufacturer, distributor, local contact point or to the National Competent Authority, if appropriate, as this provides important feedback to the manufacturer.

On behalf of Dexcom, we apologize for any inconvenience this may cause.

Sincerely,  
Dexcom Quality Compliance Team

To ensure receipt of this urgent medical device customer notification, Dexcom will send up to three communications to potentially impacted customers until an acknowledgement confirmation is received. If you do not acknowledge the alert after three communications, Dexcom will assume you are not impacted by the correction. As always, please contact Dexcom Technical Support if you are experiencing any issues.